

RAL 1003 powder coated metal

Part No. 90302ZAC/90302ZAD

Adjustable Protector kit

for Radar Sensors 100 and 200 SERIES

The adjustable protector kits are used for installing Inxpect Safety Radar Sensors in harsh indoor and outdoor environments and protect them from damage. The adjustable protector will work with both the 2-axis and 3-axis mounting brackets and is suitable for both 200 and 100 series.

Material Specifications

The adjustable protector is made with RAL 1003 powder coated metal.

Indoor version has a 30 degree slope downward and a weight of 7.4kg (16.3lbs).

Outdoor version has a 20 degree slope upward and a weight of 7.4kg (16.3lbs).



Note: chemicals and substances used in proximity of the adjustable protector kit might damage its coating, generating aesthetic imperfections. However, the functionality of the device is typically unaffected. To ensure its longevity, avoid using it in environments where chemicals or substances could damage the iron structure of the protector kit.

Adjustable Protector kit

Measures

mm
(in)
↔

Outdoor
90302ZAD

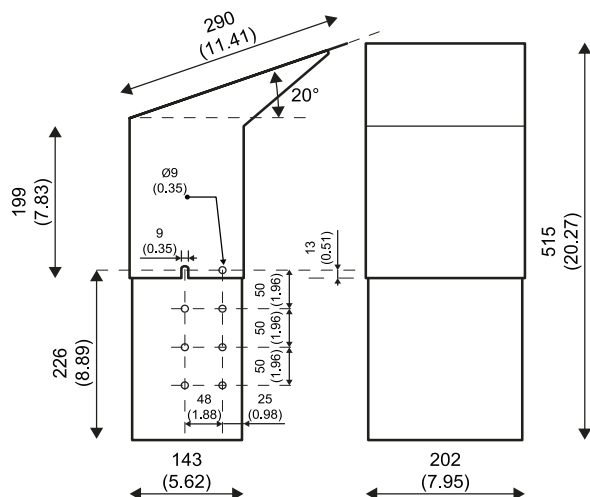

Indoor
90302ZAC

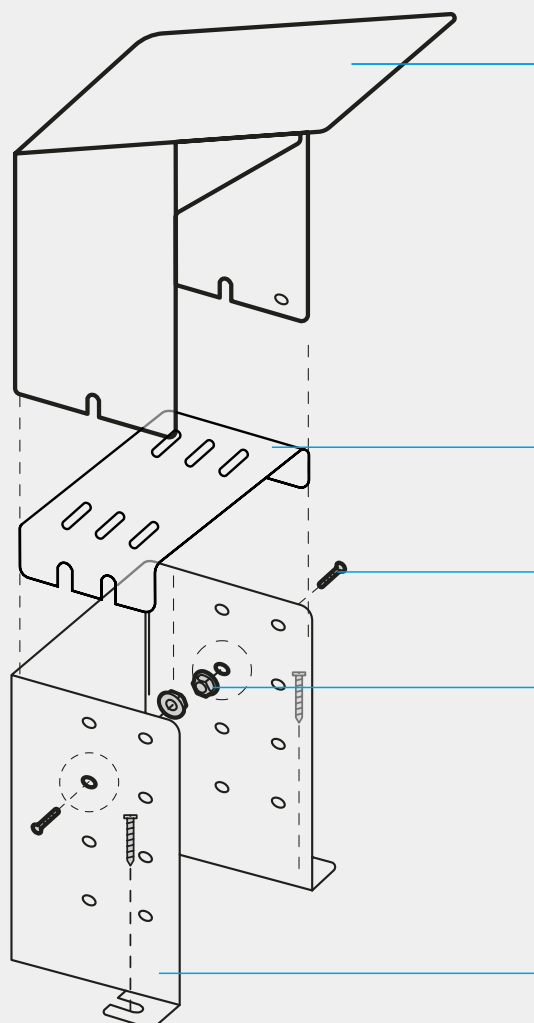
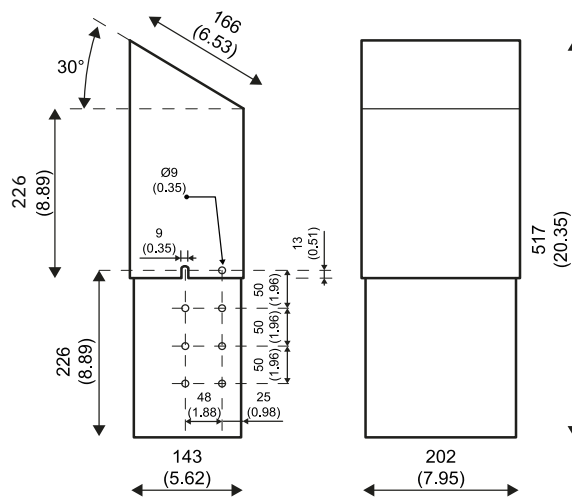

Outdoor
Sensor cover

Adjustable
sensor base

Screw

Nut

Protector base

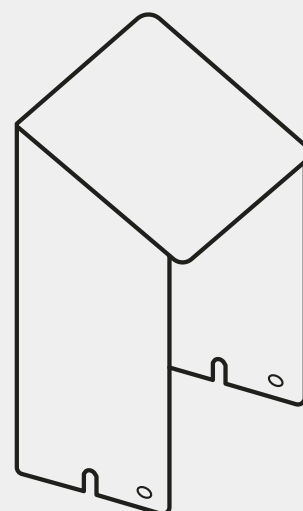

Indoor
Sensor cover